

PLAN AND PROFILE
MOUNT VERNON AVENUE
SEWER

FROM 7th STREET TO BASE LINE STREET
 SCALE'S (Vertical) 1 inch = 4 feet
 (Horizontal) 1 inch = 40 feet
 July 10, 1912
 F. A. Smith
 Civil Engineer

ABBREVIATIONS
 THE MARK () MEANS FOOT OR FEET
 ELEV MEANS ELEVATION
 RED LINES ON PLAN SHOW CENTERLINE OF SEWER
 THE LETTER S SHOWS LOCATION OF WYES

DETAILS OF QUANTITIES
 333278 LINEAL FEET 10 INCH VITRIFIED SEWER PIPE
 112-10 INCH STAINLESS WYES
 6 MANHOLES, SMAY
 1 FLUSHTRINK
 1 Conveyer (Kiln) and Manhole

SEVENTH ST.
 LEONARD AVE.
 EIGHTH ST.
 AVE.
 Manhole shown on Seventh Street Sewer Plan as Flush Tank

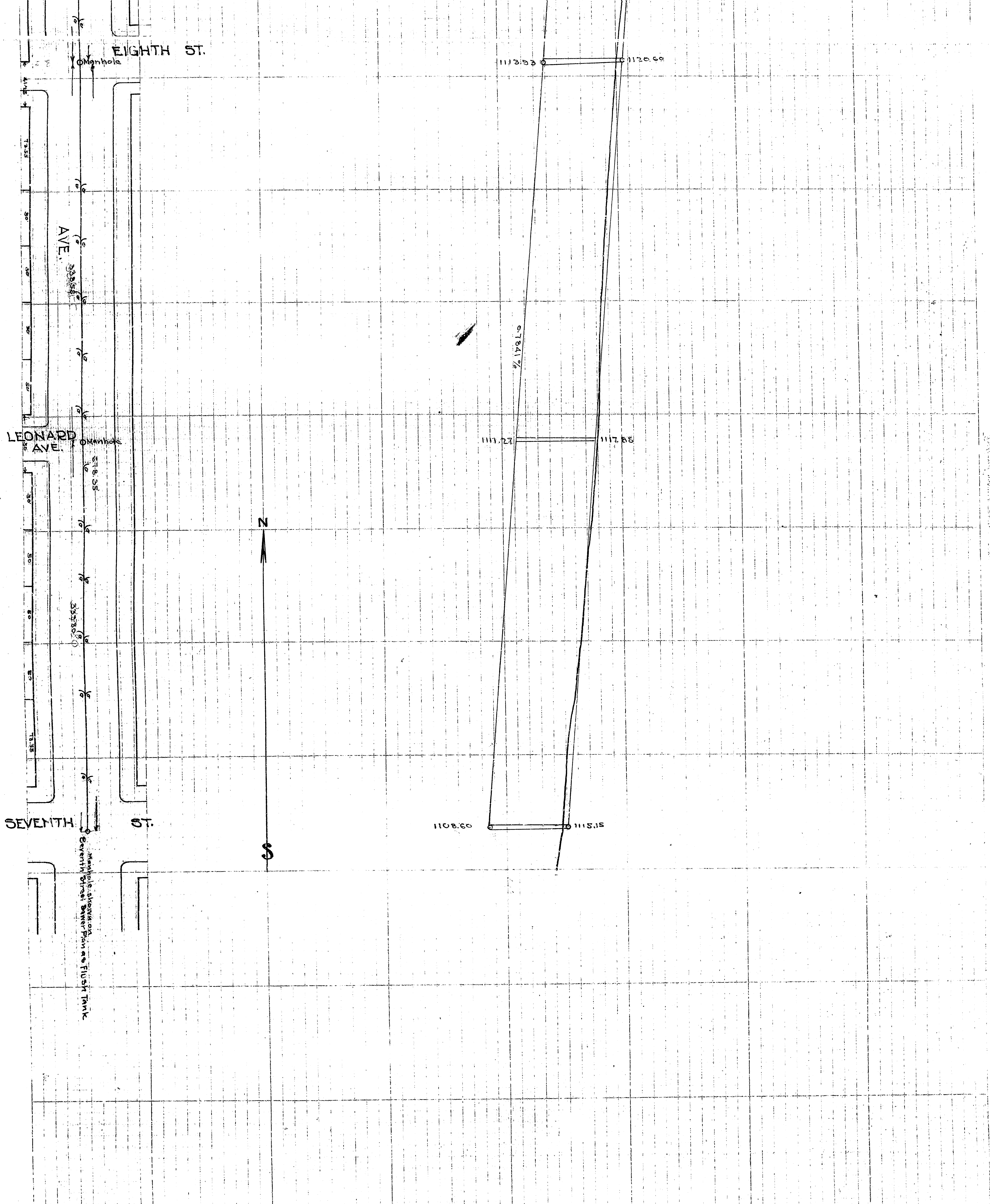

**MOUNT VERNON AVENUE
SEWER**

PLAN AND PROFILE
 FROM 7th STREET TO BASE LINE STREET
 SCALE: Vertical 1 inch = 4 feet
 Horizontal 1 inch = 40 feet
 July 10, 1912
 F. A. Smith
 Civil Engineer

ABBREVIATIONS
 THE MARK () MEANS FOOT OR FEET
 ELEV MEANS ELEVATION
 RED LINES ON PLAN SHOW CENTERLINE OF SEWER
 THE LETTER S SHOWS LOCATION OF WYES

DETAILS OF QUANTITIES
 333278 LINEAL FEET 10 INCH VITREED SEWER PIPE
 112-10 INCH STAINLESS WYES
 6 MANHOLES, 3 MAT
 1 FLUSH TRNK
 1 Conveyer (with manhole)

SEWER
 JUL 8 1912
 F. A. Smith
 Civil Engineer

EIGHTH ST.
 MANHOLE
 AVE.
 LEONARD AVE.
 MANHOLE
 SEVENTH ST.
 MANHOLE
 SEVENTH STREET SEWER FROM THE FLUSH TRNK